

CORRECTED SURVEY OF LOTS 63-63A & 64
OF INDIA SUTHERLIN ESTATE.
THE ORIGINAL MAP OF SAID ESTATE RECORDED
IN PLAT BOOK "C" PAGE 311 IN PROBATE OFFICE
ETOWAH COUNTY, ALA.
Surveyed by: *Lutheinda A. R. R. 753.*

STATE OF ALABAMA:
COUNTY OF ETOWAH:
We the undersigned, owners of the lands embraced in
this map, hereby verify and adopt the same as correct
this map, this the 22nd day of April 1989.

W. W. Frazier
Russell Frazier
B. B. Fambough
E. D. Durrin
Longwell Dunn
Thelma Stewart
Elaine Jundrow
Robert

STATE OF ALABAMA:
COUNTY OF ETOWAH:
I, G. E. Christopher, a Notary Public in and for
said County and State, do hereby certify that W. W. Frazier
and wife, Russ Tester, Russ B. Fambough, E. D. Dunn and
wife, Mrs. Smith Dunn, Thelma Stewart and wife, Elaine Jundrow
and owners of the property depicted by this map, and
who are known to me, acknowledged before me on this
date, that being informed of the contents thereof, they
executed the same voluntarily on the day and date
herein stated.

G. E. Christopher
Notary Public.

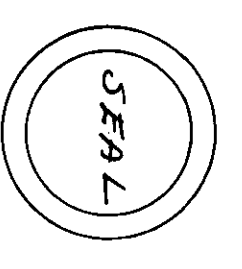

Approved: *Lutheinda City Esqr.*

Approved: *F. M. Fitts* Planning Com.

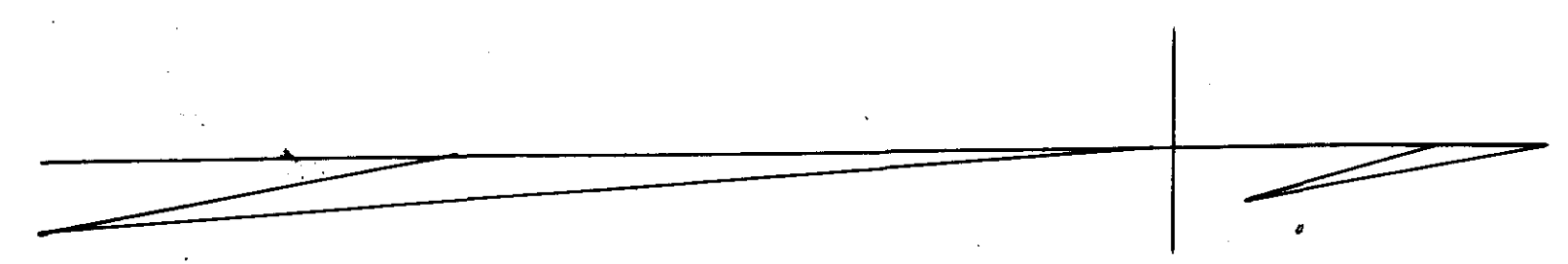
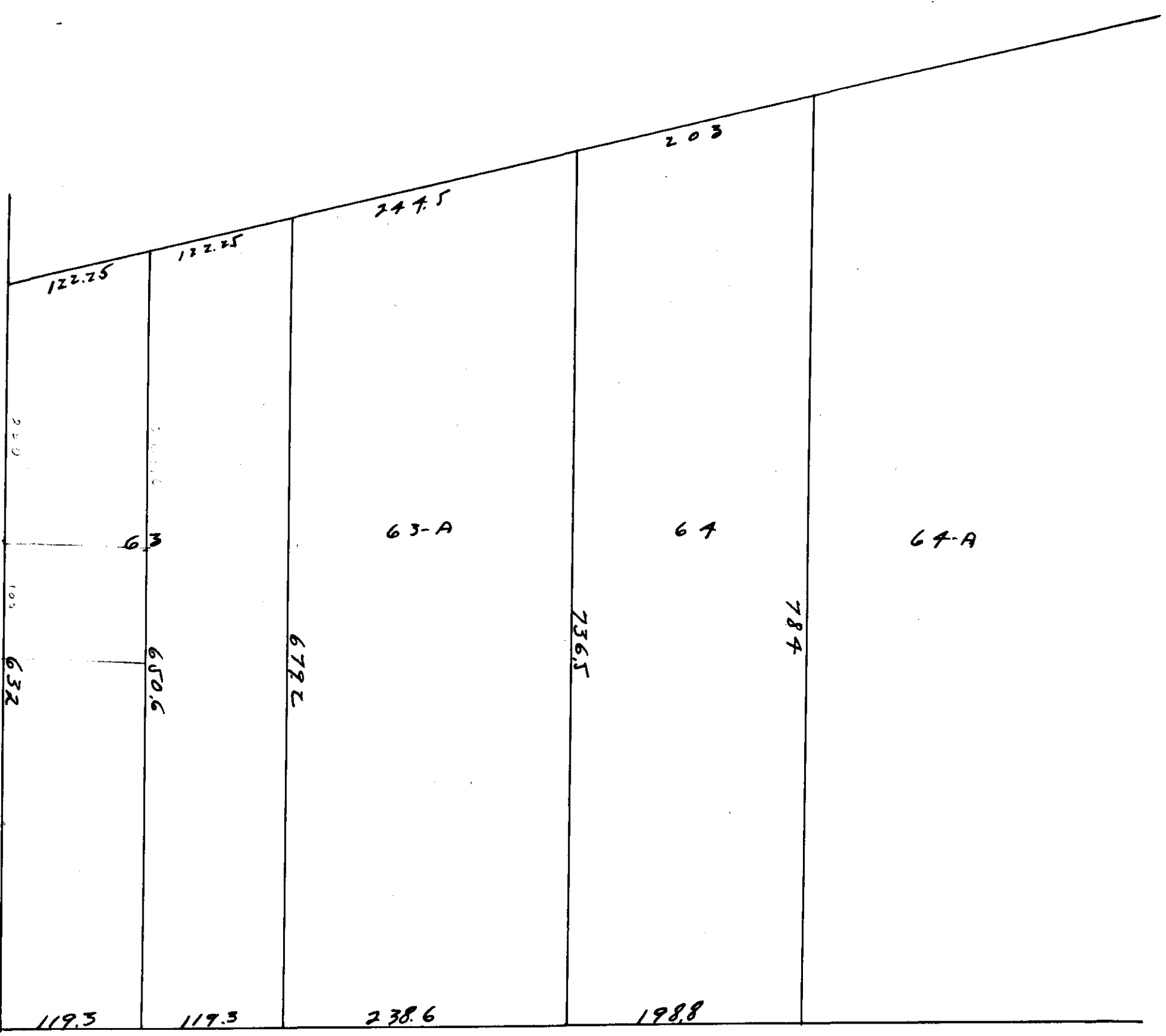

Filed in office for record on the 25th day of
April, 1989, at 12:00 P.M.
M. and duly recorded the 27th day of
April, 1989.
Frank A. Reagan
Judge of Probate