

I, W. Hill, a Civil Engineer and Surveyor hereby certify this to be a correct map of this property as subdivided by me this 6th day of November, 1906.

W. Hill CE

Annulment - Misc 115 Page 789

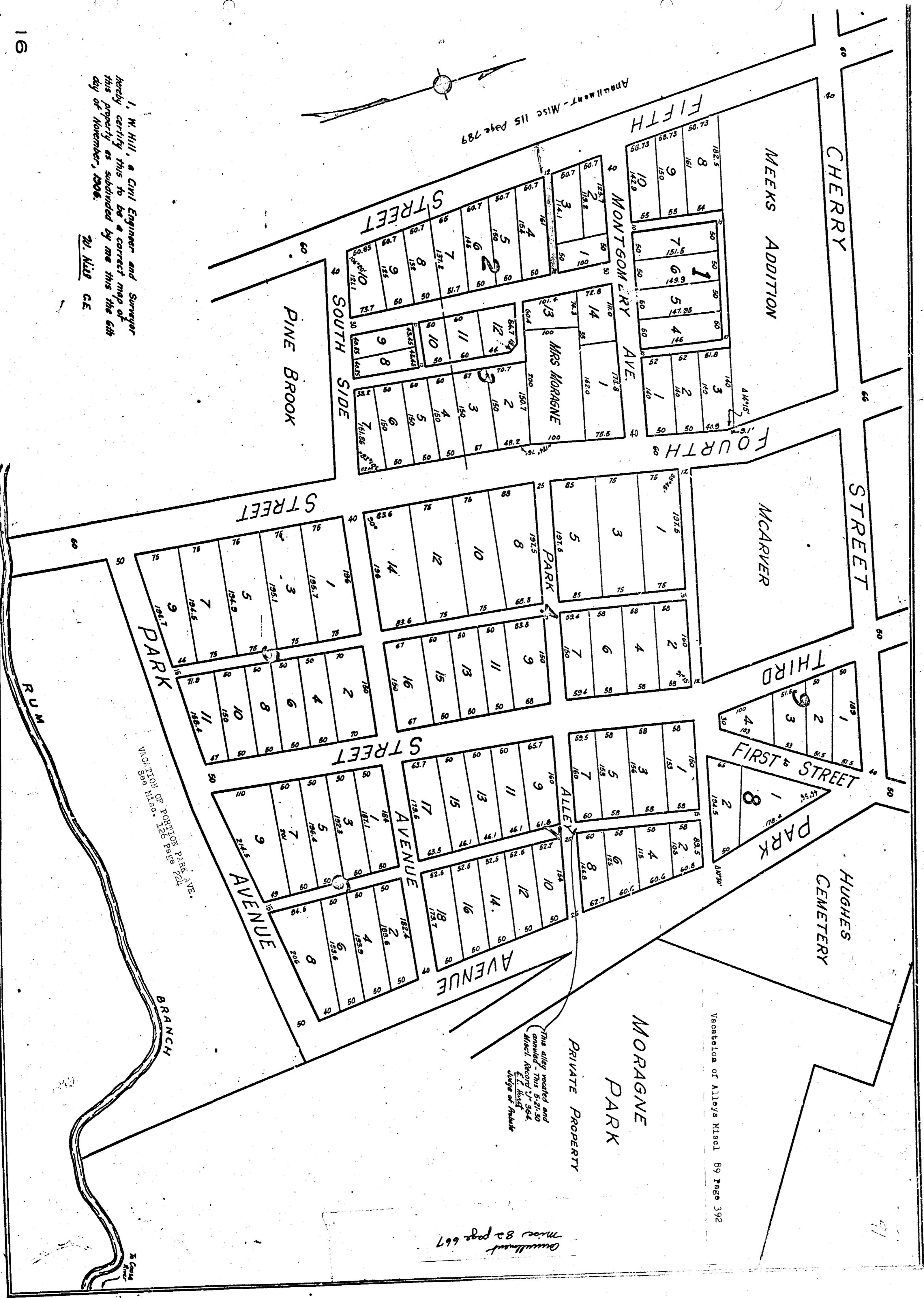
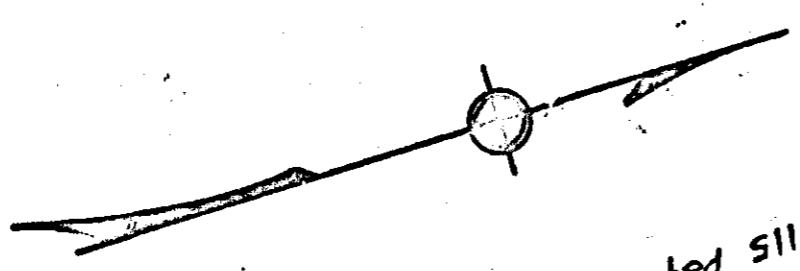

SECTION OF PORTER PARK AVE. See Misc 120 Page 222

This alley vacated and annulled - This 5-21-30 Black Record 7-344 C. L. Hill Judge of Probate

Annulment Misc 82 page 667

Vacation of Alleys Misc 89 Page 392