

N. C. & St. L. Railroad

L. & N. Railroad

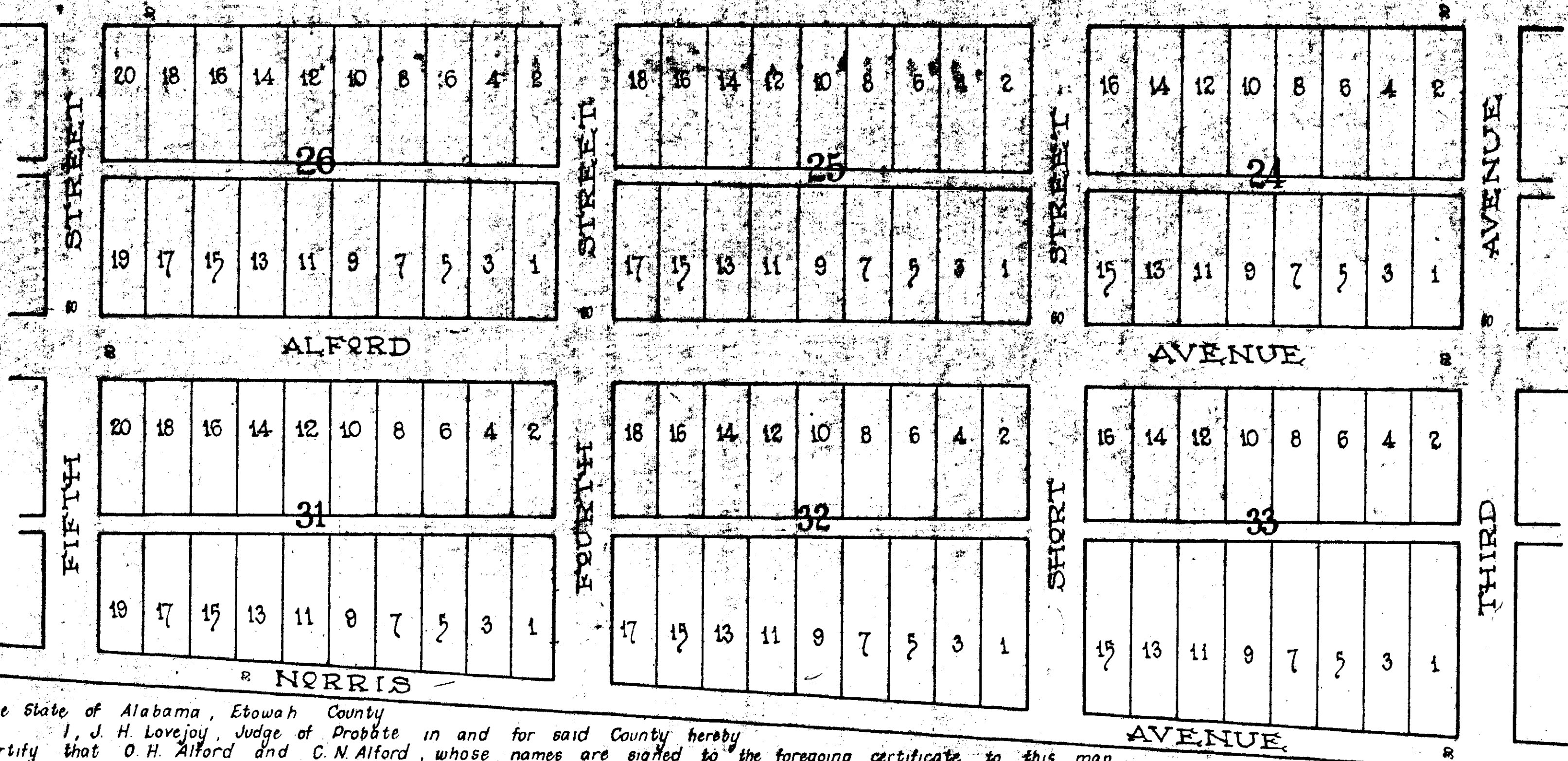

The State of Alabama, Etowah County
 I, J. H. Lovejoy, Judge of Probate in and for said County hereby certify that O. H. Alford and C. N. Alford, whose names are signed to the foregoing certificate to this map and who are known to me acknowledged before me on this day that being informed of the contents of the map and certificate, they executed the same voluntarily on the day the same bears date and that C. N. Alford, Attorney in fact for Mrs. B. P. Alford, M. L. Alford, Nannie Sue Roberts and J. O. Roberts, whose names are signed to said certificate and map, and O. H. Alford, Atty in fact for Ira F. Moss, E. D. Moss, B. M. Martin, and Cornelia C. Martin, whose names are signed to said certificate and map, acknowledged before me on this day that they respectively had powers of Attorney from the respective signers to sign said certificate & map in their names and behalf respectively and that being informed of the contents of the conveyance they executed the same respectively in the respective names of said signers voluntarily on the day the same bears date. Given under my hand this 22nd day of May, 1903.
 J. H. Lovejoy, Judge of Probate