

# JACKSON AND WILSON

ADDITION TO ATTALLA, ALA.

*For Amended by 11/1/1889  
Map-See 379-433*

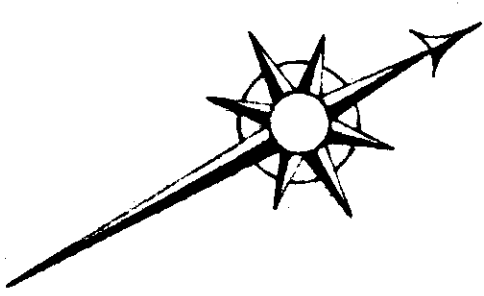
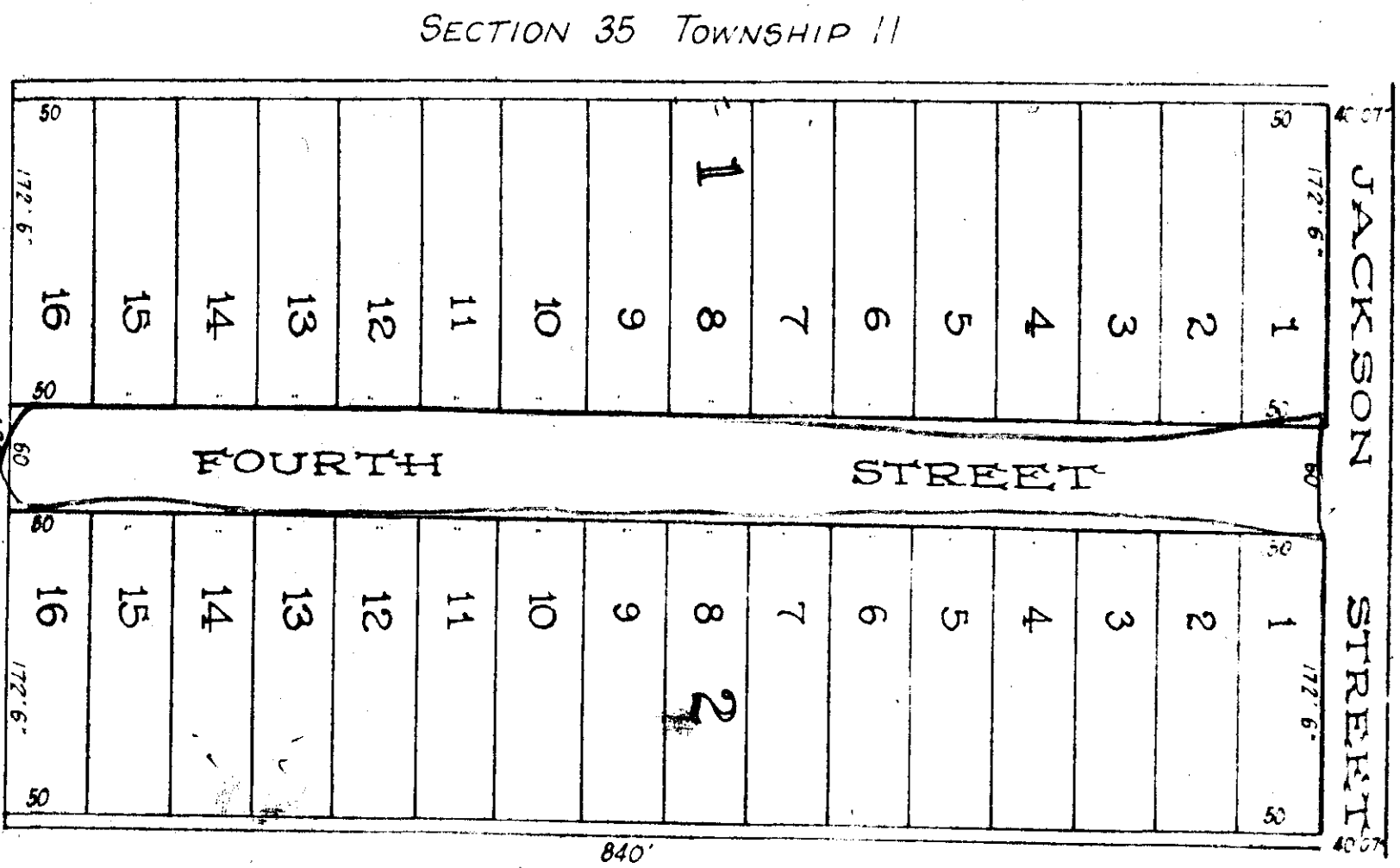

I hereby certify that this is a correct plat of the land belonging to Messrs. Jackson and Wilson situated at Attalla, Ala Eight Acres more or less of land of SE quarter of NW quarter of Section 35 Tp 11 Range 5.

John F. Jack,  
C E Attalla, Ala.

The State of Alabama, Etowah County  
We, F. E. Jackson and J. T. Wilson, owners of the land herein platted and surveyed by John F. Jack, hereby ratify and adopt the same as correct.  
Given under our hands this September 25, 1889

F. E. Jackson, (Seal)  
J. T. Wilson (Seal)

The State of Alabama, Etowah County  
I, J. A. Tallman, Judge of Probate in and for said County hereby certify that F. E. Jackson and J. T. Wilson, whose names are signed to the foregoing declaration and who are known to me acknowledged before me on this day, that being informed of the contents of the same, they executed the same voluntarily on the day the same bears date.  
Given under my hand this September 26, 1889

J. A. Tallman  
Judge of Probate  
Filed in my office for record September 25, 1889 Recorded same day.  
J. A. Tallman  
Judge of Probate